



CARNBUCK WIND FARM

FIGURE APPENDIX 12.1

DELIVERY ANALYSIS

KEY:

- EXISTING ROAD / TRACK SURFACE
- OVERRUN (HIGHWAY)
- OVERSAIL (HIGHWAY)
- OVERRUN (3rd PARTY)
- OVERSAIL (3rd PARTY)

VEHICLE PATH

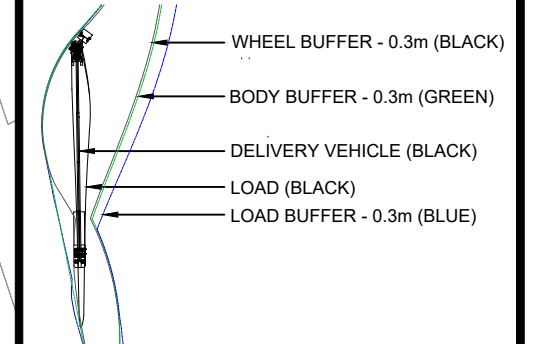

NOTES

1. AREAS OF OVERRUN AND OVERSAIL CONSIDER THE COMBINED AREA FOR ALL ASSESSED VEHICLES.
2. VEHICLE DIMENSIONS BASED ON TYPICAL DELIVERY VEHICLES AND SHOULD BE CONFIRMED PRIOR TO DELIVERY.
2. VEHICLE MODELS HAVE A 0.3m FACTOR OF SAFETY.
3. LAND TAKE IS APPROXIMATE AND INCLUDES OVERRUN, OVERSAIL AND TEMPORARY WORKS.
4. ALL RELEVANT AUTHORITIES TO BE CONSULTED ON RELOCATION / REMOVAL OF STREET FURNITURE.
5. VEGETATION WILL BE TRIMMED BACK WHERE REQUIRED WITHIN HIGHWAY CORRIDOR

DETAIL 13 & 14
SHEET 10 OF 16

LAYOUT DWG N/A T-LAYOUT NO. N/A

DRAWING NUMBER	REV
03090-RES-ACC-DR-LO-001	1

SCALE - 1:500 @ A3

**ENVIRONMENTAL STATEMENT
2022**

THIS DRAWING IS THE PROPERTY OF RENEWABLE ENERGY SYSTEMS LTD. AND NO REPRODUCTION MAY BE MADE IN WHOLE OR IN PART WITHOUT PERMISSION

DETAIL 13
V136 BLADE DELIVERY VEHICLE
REAR AXLE MANUAL OVERRIDE USED

DETAIL 14
V136 BLADE DELIVERY VEHICLE
REAR AXLE MANUAL OVERRIDE USED





CARNBUCK WIND FARM

FIGURE APPENDIX 12.1

DELIVERY ANALYSIS

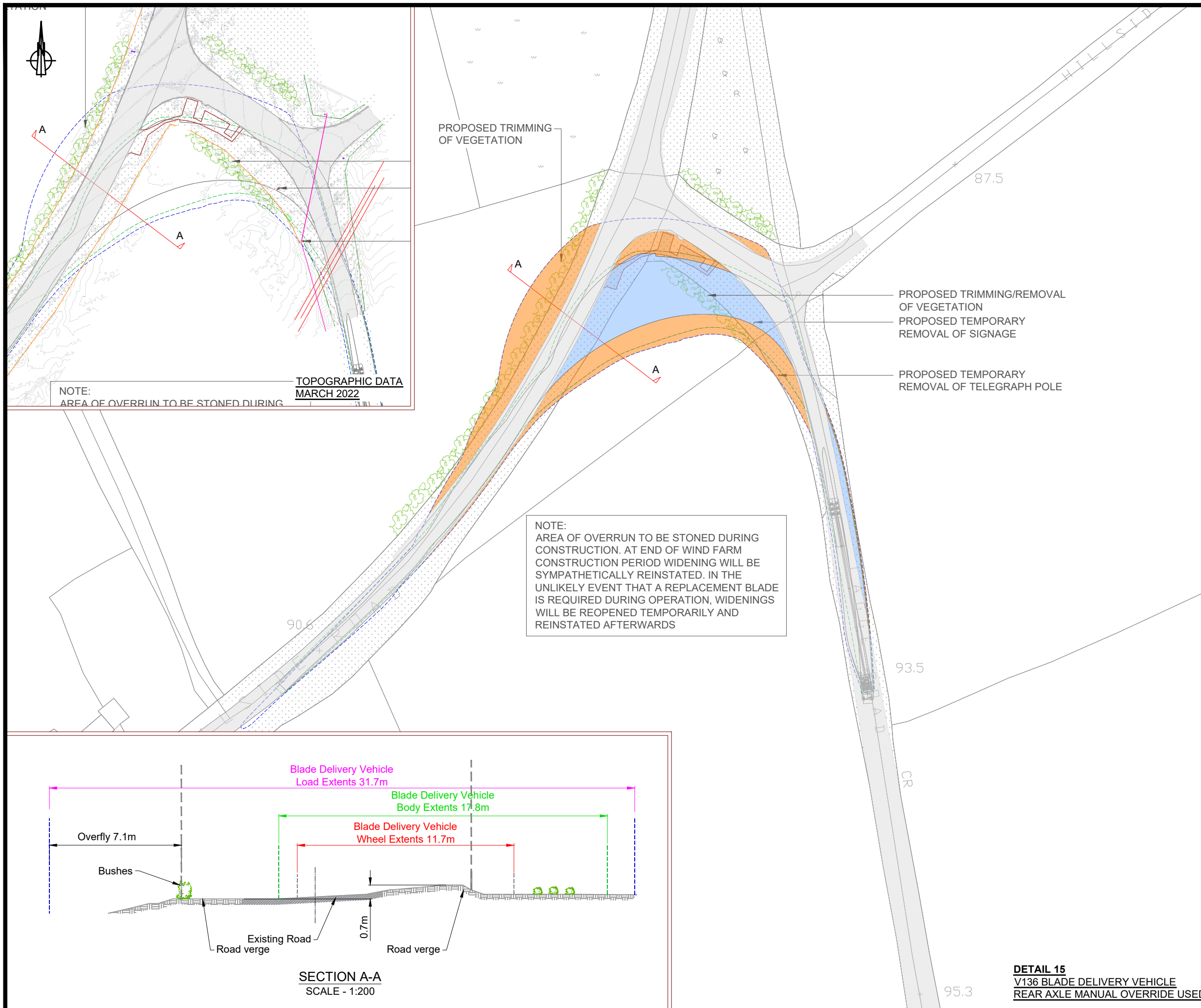

- KEY:**
- EXISTING ROAD / TRACK SURFACE
 - OVERRUN (HIGHWAY)
 - OVERSAIL (HIGHWAY)
 - OVERRUN (3rd PARTY)
 - OVERSAIL (3rd PARTY)

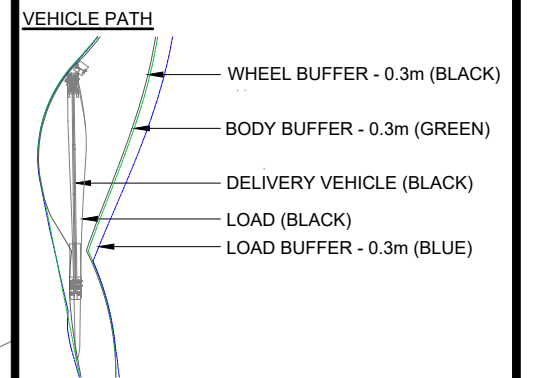

- NOTES**
1. AREAS OF OVERRUN AND OVERSAIL CONSIDER THE COMBINED AREA FOR ALL ASSESSED VEHICLES.
 2. VEHICLE DIMENSIONS BASED ON TYPICAL DELIVERY VEHICLES AND SHOULD BE CONFIRMED PRIOR TO DELIVERY.
 2. VEHICLE MODELS HAVE A 0.3m FACTOR OF SAFETY.
 3. LAND TAKE IS APPROXIMATE AND INCLUDES OVERRUN, OVERSAIL AND TEMPORARY WORKS.
 4. ALL RELEVANT AUTHORITIES TO BE CONSULTED ON RELOCATION / REMOVAL OF STREET FURNITURE.
 5. VEGETATION WILL BE TRIMMED BACK WHERE REQUIRED WITHIN HIGHWAY CORRIDOR

NOTE: AREA OF OVERRUN TO BE STONED DURING CONSTRUCTION. AT END OF WIND FARM CONSTRUCTION PERIOD WIDENING WILL BE SYMPATHETICALLY REINSTATED. IN THE UNLIKELY EVENT THAT A REPLACEMENT BLADE IS REQUIRED DURING OPERATION, WIDENINGS WILL BE REOPENED TEMPORARILY AND REINSTATED AFTERWARDS

NOTE: AREA OF OVERRUN TO BE STONED DURING CONSTRUCTION. AT END OF WIND FARM CONSTRUCTION PERIOD WIDENING WILL BE SYMPATHETICALLY REINSTATED. IN THE UNLIKELY EVENT THAT A REPLACEMENT BLADE IS REQUIRED DURING OPERATION, WIDENINGS WILL BE REOPENED TEMPORARILY AND REINSTATED AFTERWARDS

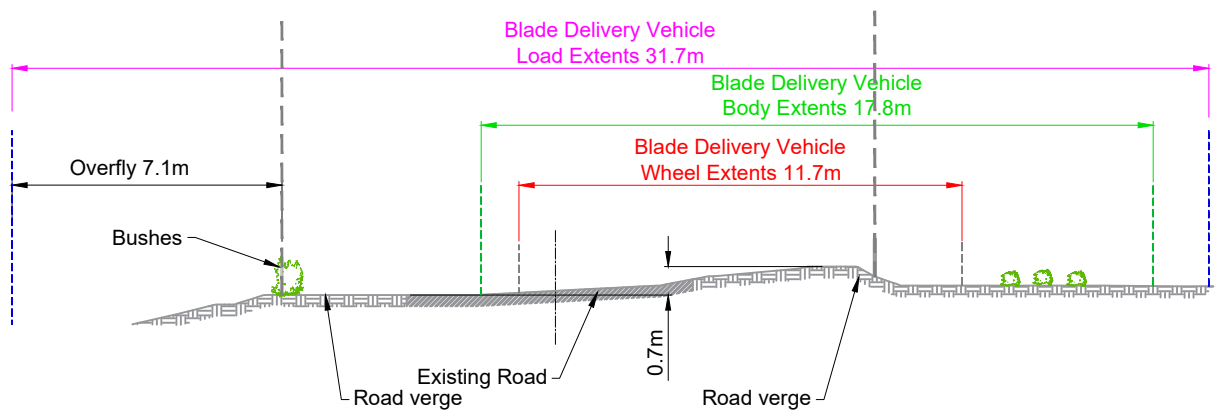

SECTION A-A
SCALE - 1:200

DETAIL 15
V136 BLADE DELIVERY VEHICLE
REAR AXLE MANUAL OVERRIDE USED

DETAIL 15
SHEET 11 OF 16

LAYOUT DWG	N/A	T-LAYOUT NO.	N/A
DRAWING NUMBER	03090-RES-ACC-DR-LO-001	REV	1

SCALE - 1:1000 @ A3

ENVIRONMENTAL STATEMENT
2022

THIS DRAWING IS THE PROPERTY OF RENEWABLE ENERGY SYSTEMS LTD. AND NO REPRODUCTION MAY BE MADE IN WHOLE OR IN PART WITHOUT PERMISSION

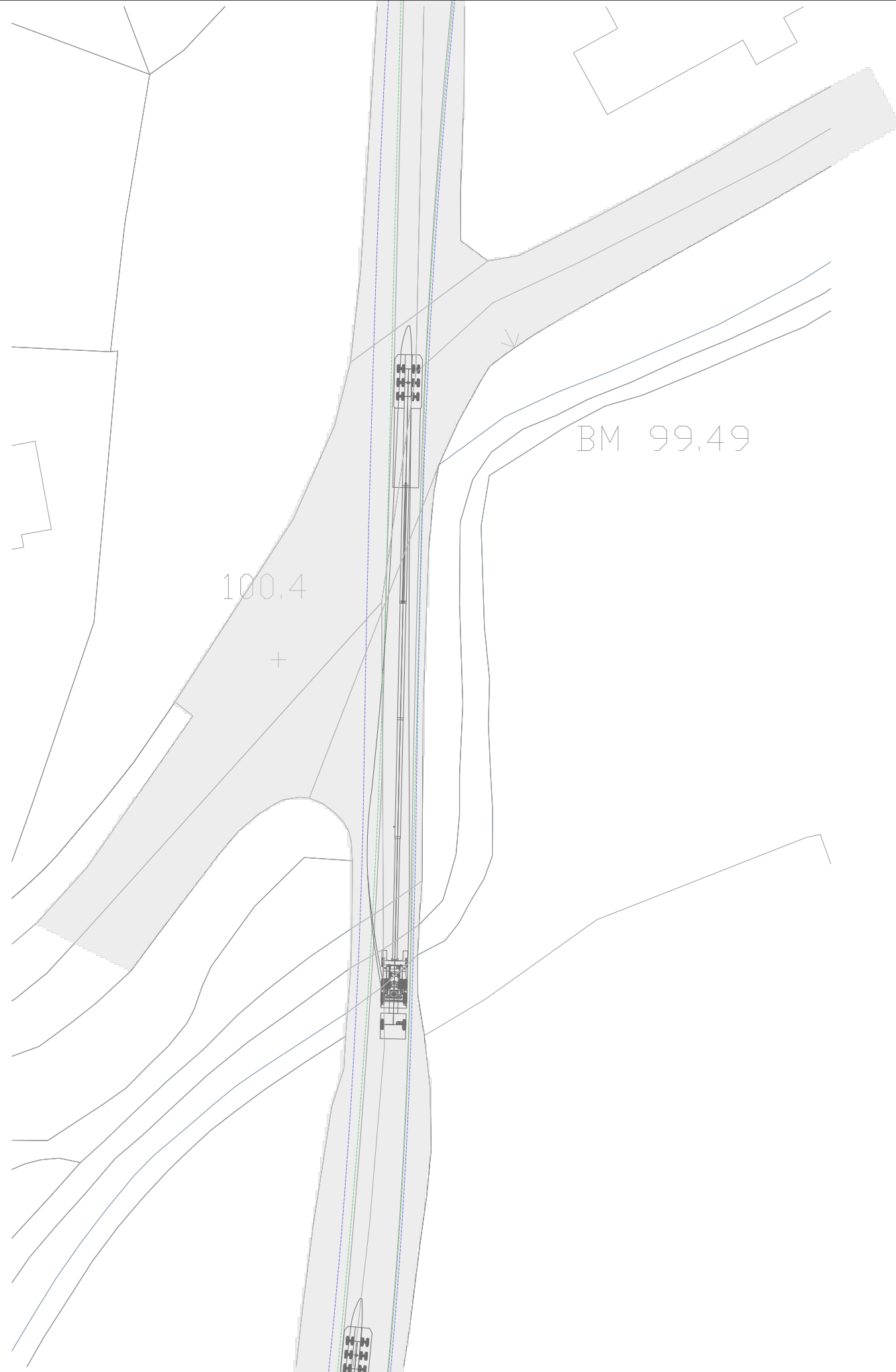

**CARNBUCK
WIND FARM**

FIGURE APPENDIX 12.1

DELIVERY ANALYSIS

KEY:

- EXISTING ROAD / TRACK SURFACE
- OVERRUN (HIGHWAY)
- OVERSAIL (HIGHWAY)
- OVERRUN (3rd PARTY)
- OVERSAIL (3rd PARTY)

VEHICLE PATH

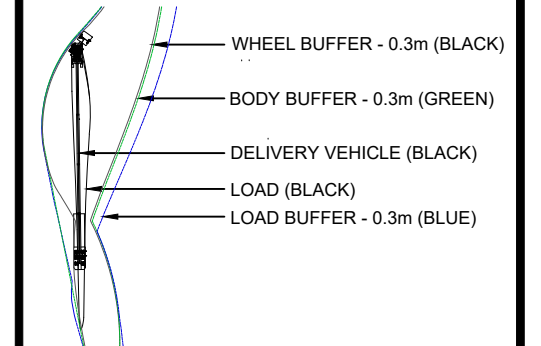

NOTES

1. AREAS OF OVERRUN AND OVERSAIL CONSIDER THE COMBINED AREA FOR ALL ASSESSED VEHICLES.
2. VEHICLE DIMENSIONS BASED ON TYPICAL DELIVERY VEHICLES AND SHOULD BE CONFIRMED PRIOR TO DELIVERY.
2. VEHICLE MODELS HAVE A 0.3m FACTOR OF SAFETY.
3. LAND TAKE IS APPROXIMATE AND INCLUDES OVERRUN, OVERSAIL AND TEMPORARY WORKS.
4. ALL RELEVANT AUTHORITIES TO BE CONSULTED ON RELOCATION / REMOVAL OF STREET FURNITURE.
5. VEGETATION WILL BE TRIMMED BACK WHERE REQUIRED WITHIN HIGHWAY CORRIDOR

DETAIL 16
SHEET 12 OF 16

LAYOUT DWG N/A T-LAYOUT NO. N/A

DRAWING NUMBER 03090-RES-ACC-DR-LO-001 REV 1

SCALE - 1:1000 @ A3

**ENVIRONMENTAL STATEMENT
2022**

DETAIL 16
V136 BLADE DELIVERY VEHICLE
REAR AXLE MANUAL OVERRIDE USED

THIS DRAWING IS THE PROPERTY OF RENEWABLE ENERGY SYSTEMS LTD. AND NO REPRODUCTION MAY BE MADE IN WHOLE OR IN PART WITHOUT PERMISSION



CARNBUCK WIND FARM

FIGURE APPENDIX 12.1

DELIVERY ANALYSIS

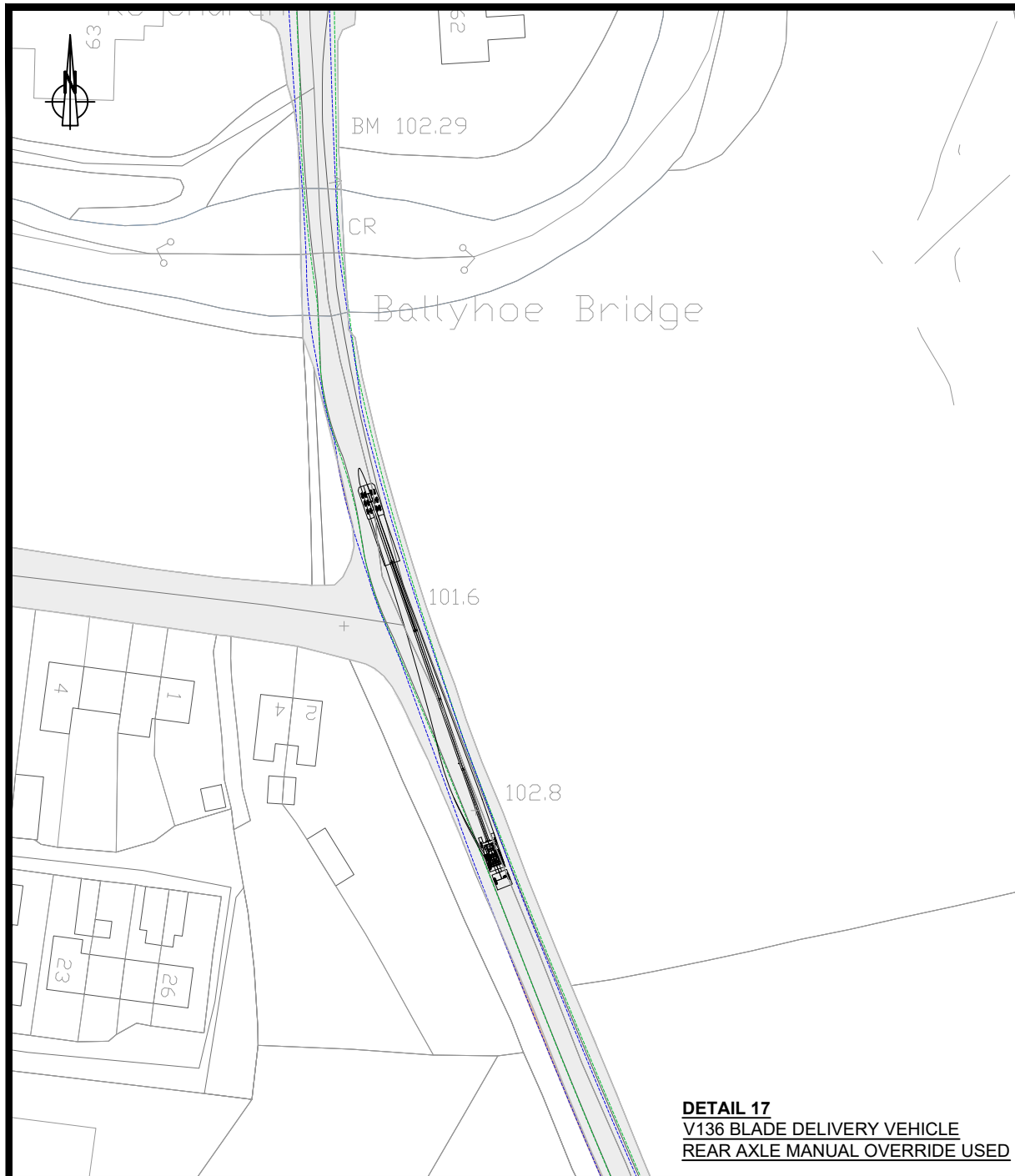

DETAIL 17
V136 BLADE DELIVERY VEHICLE
REAR AXLE MANUAL OVERRIDE USED

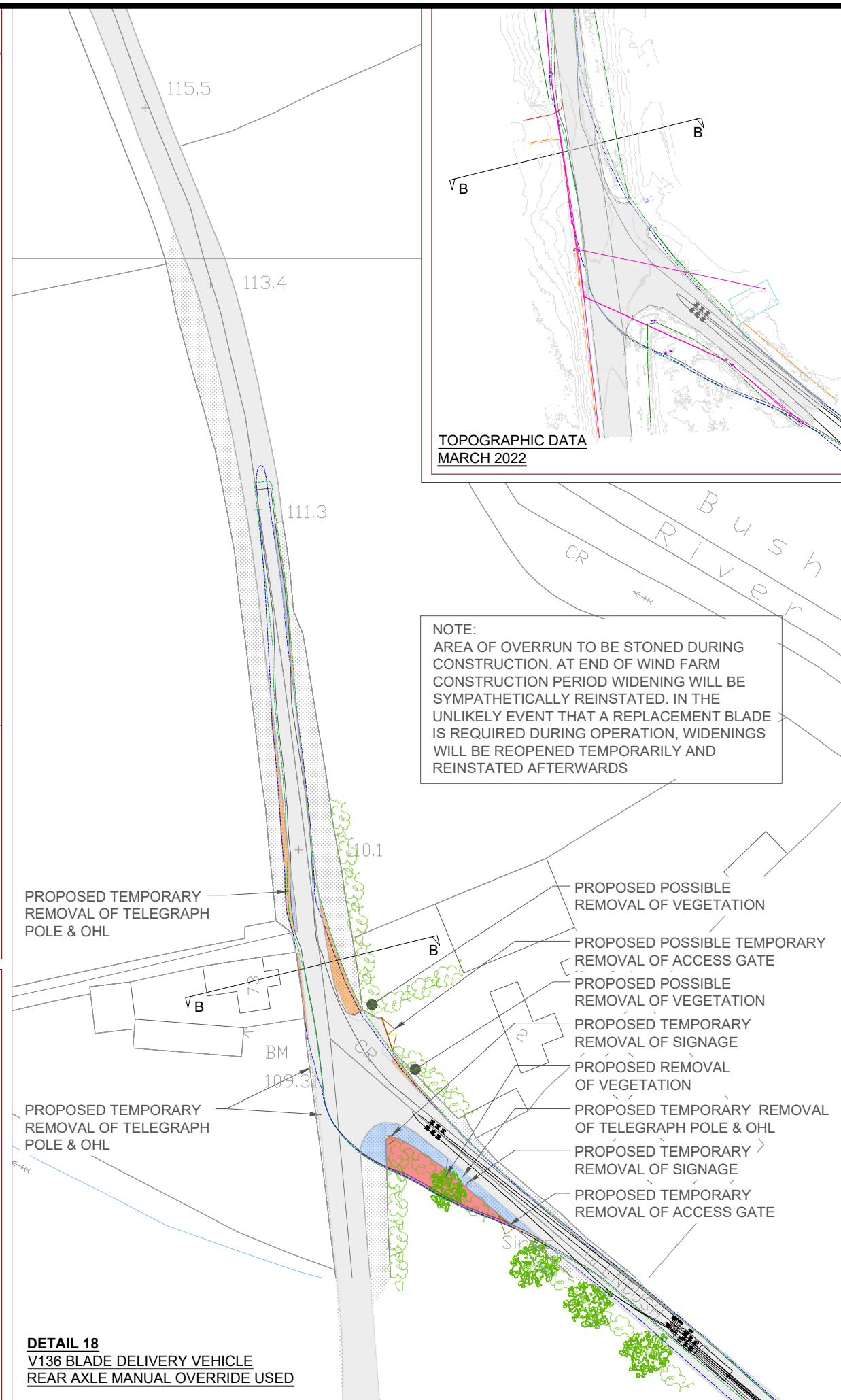
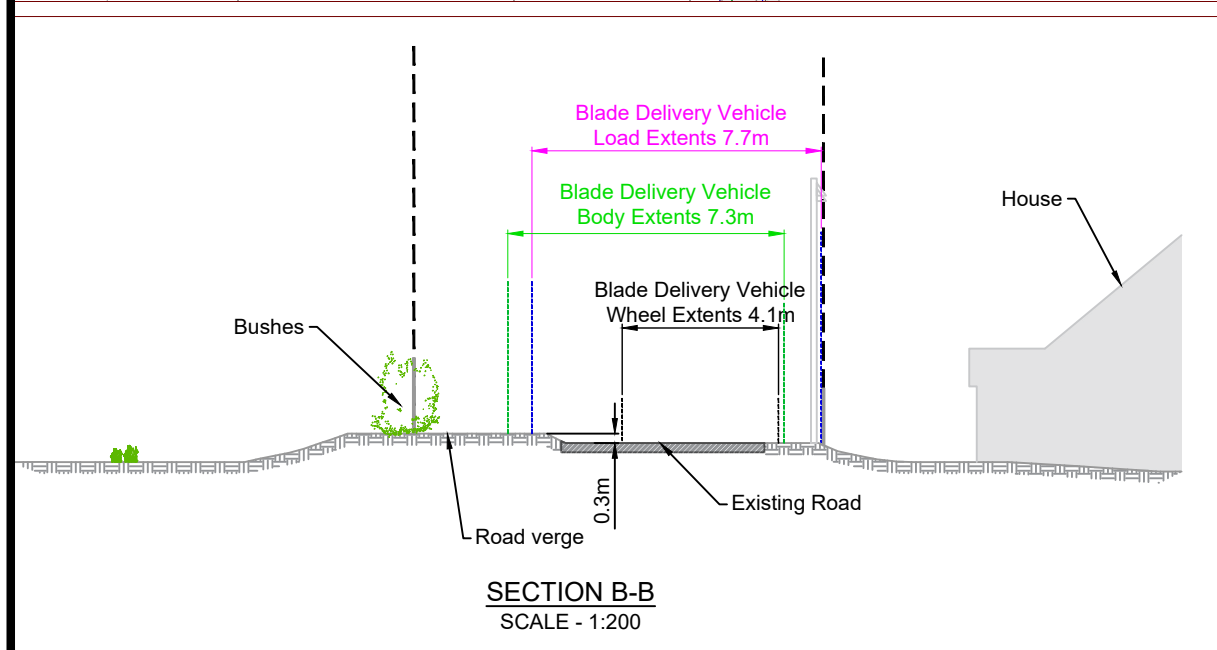

DETAIL 18
V136 BLADE DELIVERY VEHICLE
REAR AXLE MANUAL OVERRIDE USED

TOPOGRAPHIC DATA
MARCH 2022

- KEY:**
- EXISTING ROAD / TRACK SURFACE
 - OVERRUN (HIGHWAY)
 - OVERSAIL (HIGHWAY)
 - OVERRUN (3rd PARTY)
 - OVERSAIL (3rd PARTY)

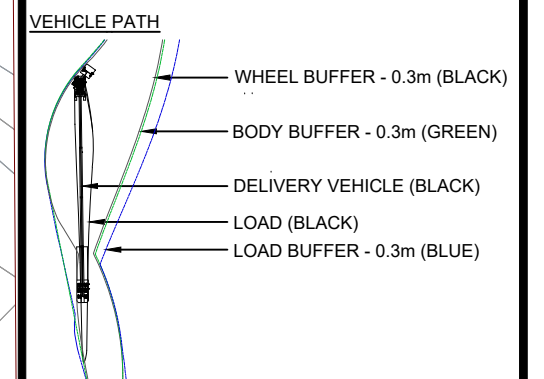

- NOTES**
1. AREAS OF OVERRUN AND OVERSAIL CONSIDER THE COMBINED AREA FOR ALL ASSESSED VEHICLES.
 2. VEHICLE DIMENSIONS BASED ON TYPICAL DELIVERY VEHICLES AND SHOULD BE CONFIRMED PRIOR TO DELIVERY.
 2. VEHICLE MODELS HAVE A 0.3m FACTOR OF SAFETY.
 3. LAND TAKE IS APPROXIMATE AND INCLUDES OVERRUN, OVERSAIL AND TEMPORARY WORKS.
 4. ALL RELEVANT AUTHORITIES TO BE CONSULTED ON RELOCATION / REMOVAL OF STREET FURNITURE.
 5. VEGETATION WILL BE TRIMMED BACK WHERE REQUIRED WITHIN HIGHWAY CORRIDOR

DETAIL 17 & 18
SHEET 13 OF 16

LAYOUT DWG N/A T-LAYOUT NO. N/A

DRAWING NUMBER **03090-RES-ACC-DR-LO-001** REV **1**

SCALE - 1:1000 @ A3

ENVIRONMENTAL STATEMENT
2022

THIS DRAWING IS THE PROPERTY OF RENEWABLE ENERGY SYSTEMS LTD. AND NO REPRODUCTION MAY BE MADE IN WHOLE OR IN PART WITHOUT PERMISSION



CARNBUCK WIND FARM
FIGURE APPENDIX 12.1
DELIVERY ANALYSIS

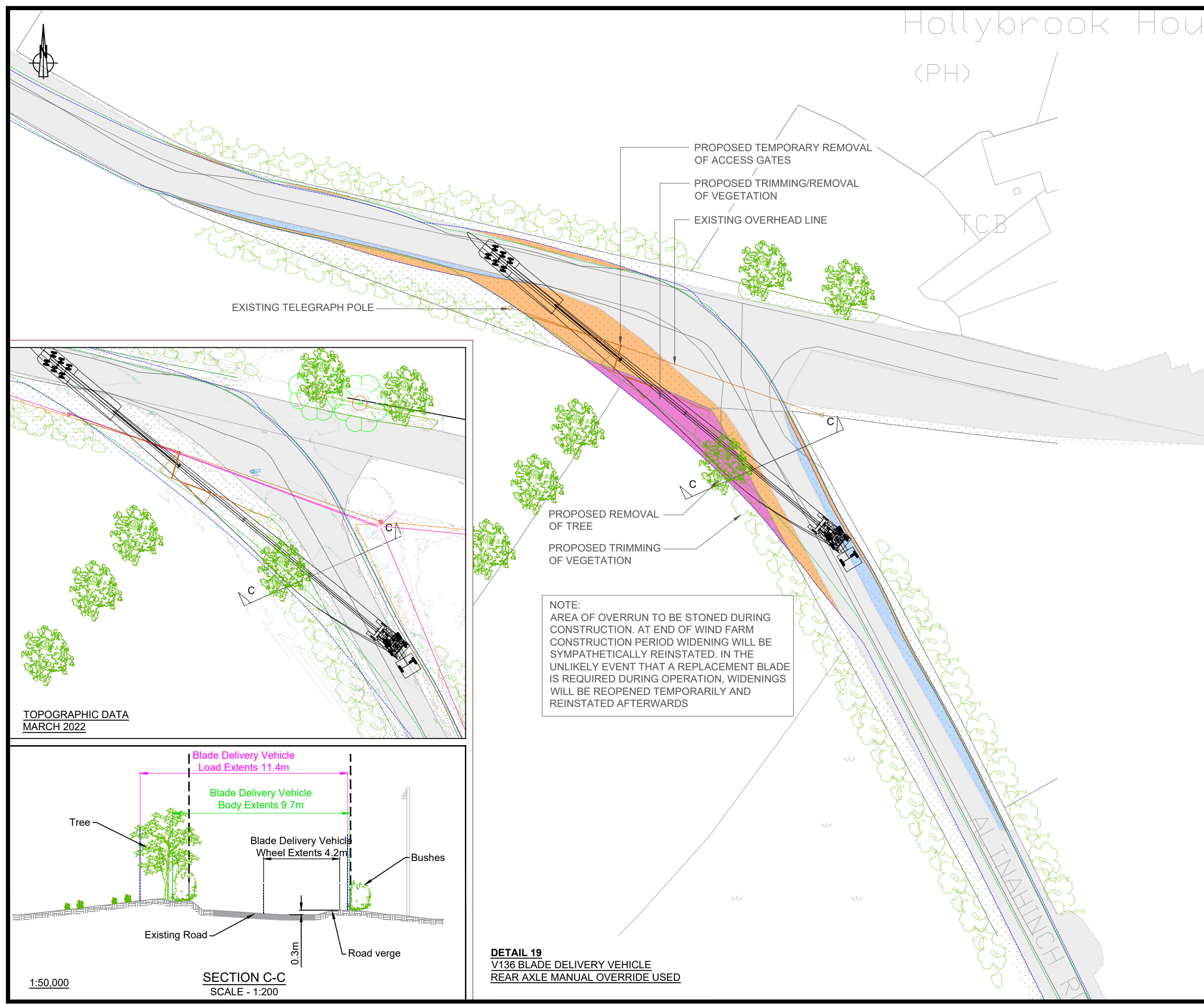

NOTE:
AREA OF OVERRUN TO BE STONED DURING CONSTRUCTION. AT END OF WIND FARM CONSTRUCTION PERIOD WIDENING WILL BE SYMPATHETICALLY REINSTATED. IN THE UNLIKELY EVENT THAT A REPLACEMENT BLADE IS REQUIRED DURING OPERATION, WIDENINGS WILL BE REOPENED TEMPORARILY AND REINSTATED AFTERWARDS

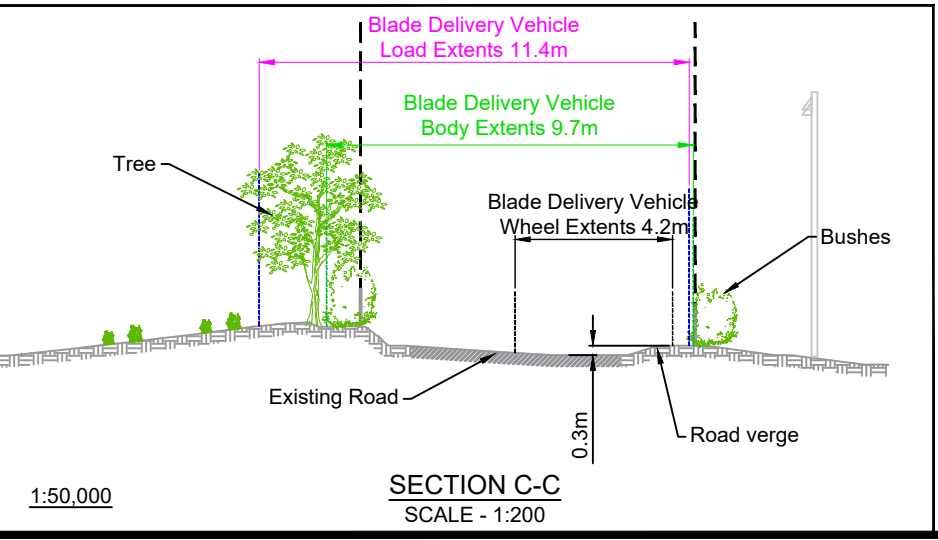
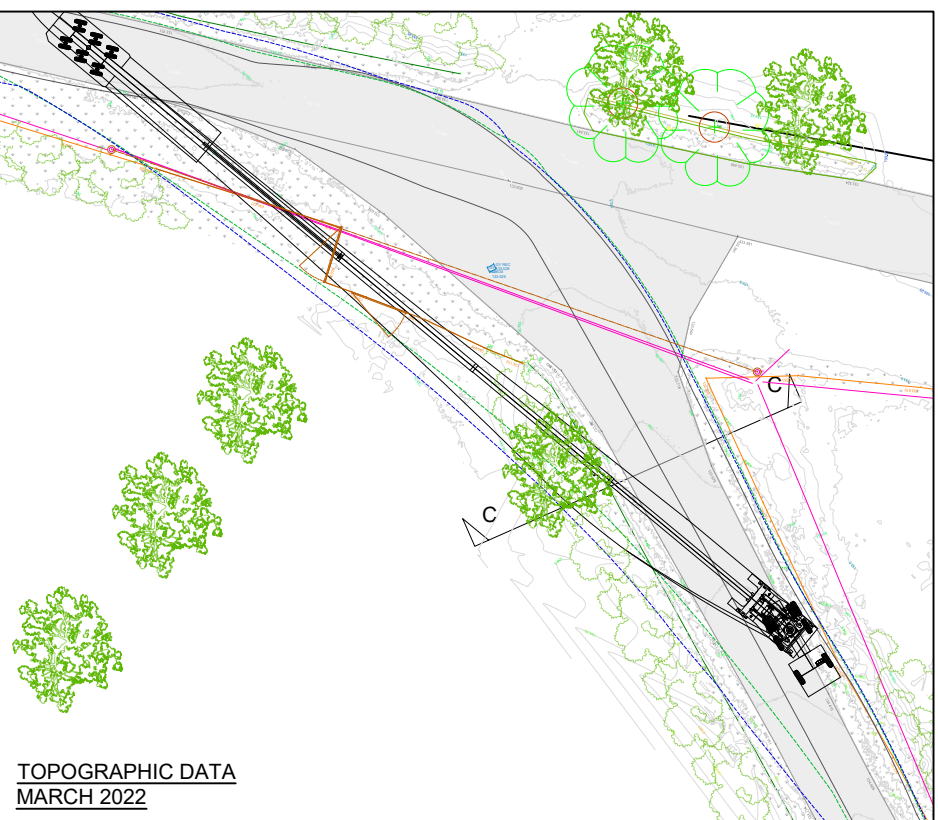

- KEY:**
- EXISTING ROAD / TRACK SURFACE
 - OVERRUN (HIGHWAY)
 - OVERSAIL (HIGHWAY)
 - OVERRUN (3rd PARTY)
 - OVERSAIL (3rd PARTY)

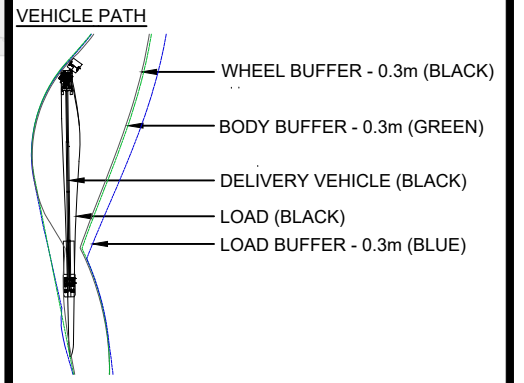

- NOTES**
1. AREAS OF OVERRUN AND OVERSAIL CONSIDER THE COMBINED AREA FOR ALL ASSESSED VEHICLES.
 2. VEHICLE DIMENSIONS BASED ON TYPICAL DELIVERY VEHICLES AND SHOULD BE CONFIRMED PRIOR TO DELIVERY.
 2. VEHICLE MODELS HAVE A 0.3m FACTOR OF SAFETY.
 3. LAND TAKE IS APPROXIMATE AND INCLUDES OVERRUN, OVERSAIL AND TEMPORARY WORKS. ALL RELEVANT AUTHORITIES TO BE CONSULTED ON RELOCATION / REMOVAL OF STREET FURNITURE.
 5. VEGETATION WILL BE TRIMMED BACK WHERE REQUIRED WITHIN HIGHWAY CORRIDOR

DETAIL 19
SHEET 14 OF 16

LAYOUT DWG	N/A	T-LAYOUT NO.	N/A
DRAWING NUMBER	03090-RES-ACC-DR-LO-001	REV	1

SCALE - 1:500 @ A3

ENVIRONMENTAL STATEMENT
2022

THIS DRAWING IS THE PROPERTY OF RENEWABLE ENERGY SYSTEMS LTD. AND NO REPRODUCTION MAY BE MADE IN WHOLE OR IN PART WITHOUT PERMISSION

DETAIL 19
V136 BLADE DELIVERY VEHICLE
REAR AXLE MANUAL OVERRIDE USED



CARNBUCK WIND FARM

FIGURE APPENDIX 12.1

DELIVERY ANALYSIS

KEY:

- EXISTING ROAD / TRACK SURFACE
- OVERRUN (HIGHWAY)
- OVERSAIL (HIGHWAY)
- OVERRUN (3rd PARTY)
- OVERSAIL (3rd PARTY)

VEHICLE PATH

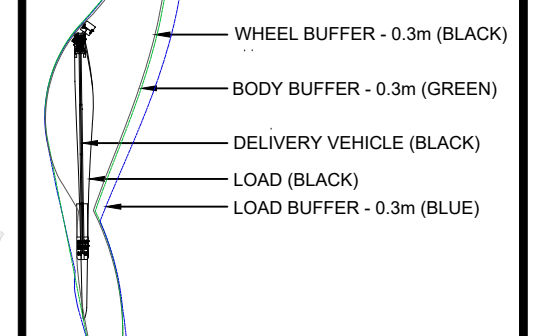

NOTES

1. AREAS OF OVERRUN AND OVERSAIL CONSIDER THE COMBINED AREA FOR ALL ASSESSED VEHICLES.
2. VEHICLE DIMENSIONS BASED ON TYPICAL DELIVERY VEHICLES AND SHOULD BE CONFIRMED PRIOR TO DELIVERY.
2. VEHICLE MODELS HAVE A 0.3m FACTOR OF SAFETY.
3. LAND TAKE IS APPROXIMATE AND INCLUDES OVERRUN, OVERSAIL AND TEMPORARY WORKS.
4. ALL RELEVANT AUTHORITIES TO BE CONSULTED ON RELOCATION / REMOVAL OF STREET FURNITURE.
5. VEGETATION WILL BE TRIMMED BACK WHERE REQUIRED WITHIN HIGHWAY CORRIDOR

DETAIL 20 & 21
SHEET 15 OF 16

LAYOUT DWG N/A T-LAYOUT NO. N/A

DRAWING NUMBER **03090-RES-ACC-DR-LO-001** REV **1**

SCALE - 1:500 @ A3

ENVIRONMENTAL STATEMENT
2022

THIS DRAWING IS THE PROPERTY OF RENEWABLE ENERGY SYSTEMS LTD. AND NO REPRODUCTION MAY BE MADE IN WHOLE OR IN PART WITHOUT PERMISSION

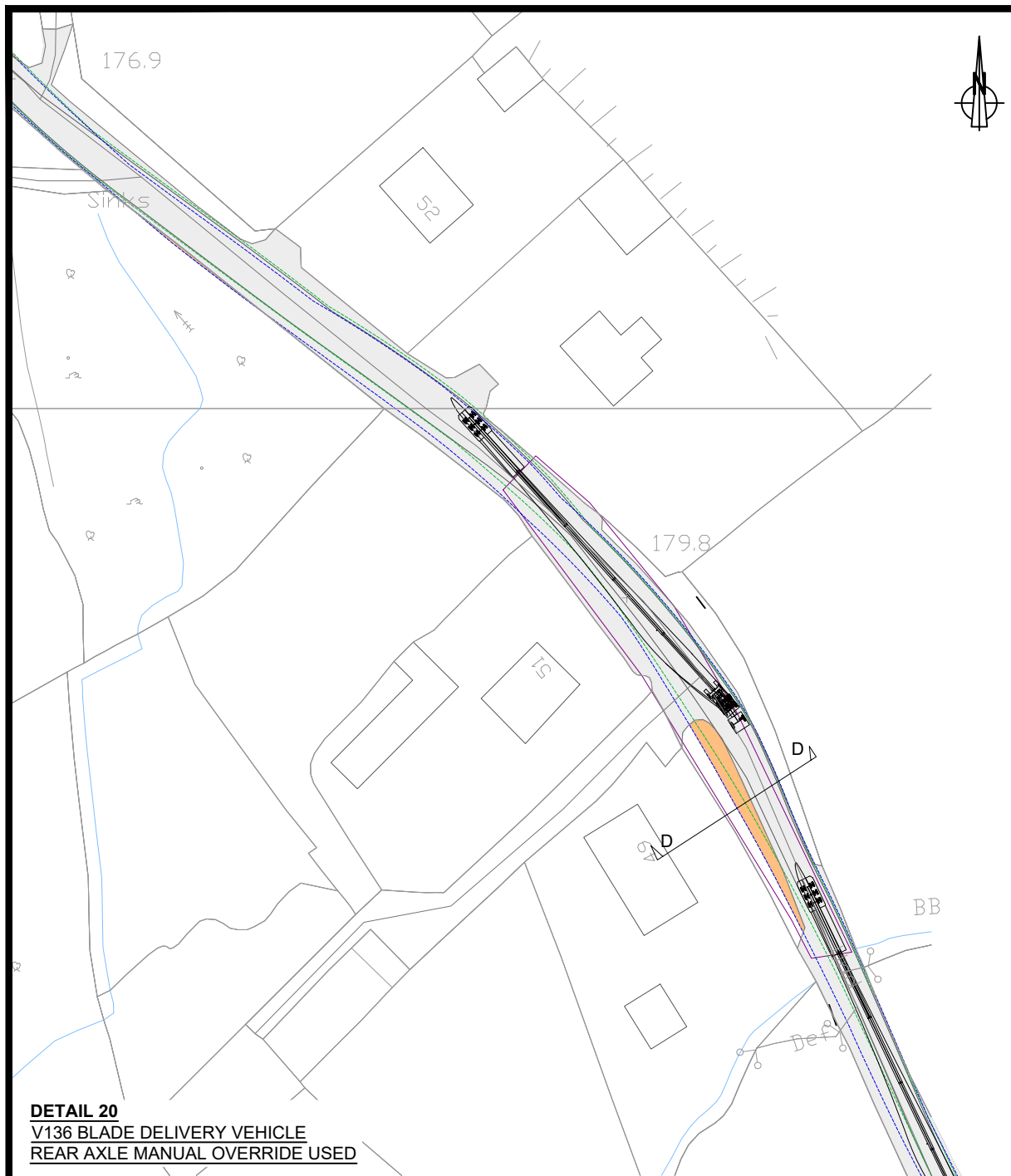

DETAIL 20
V136 BLADE DELIVERY VEHICLE
REAR AXLE MANUAL OVERRIDE USED

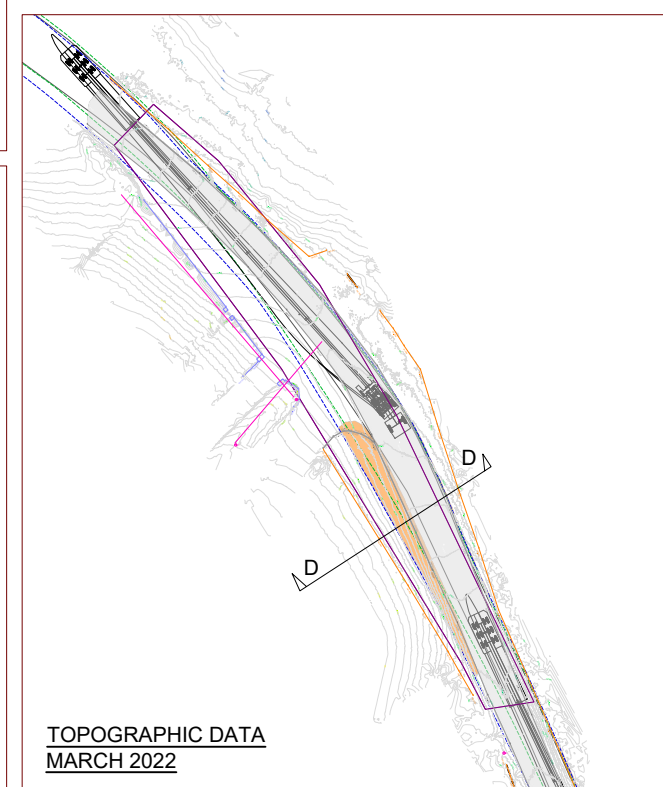

TOPOGRAPHIC DATA
MARCH 2022

DETAIL 21
V136 BLADE DELIVERY VEHICLE
REAR AXLE MANUAL OVERRIDE USED

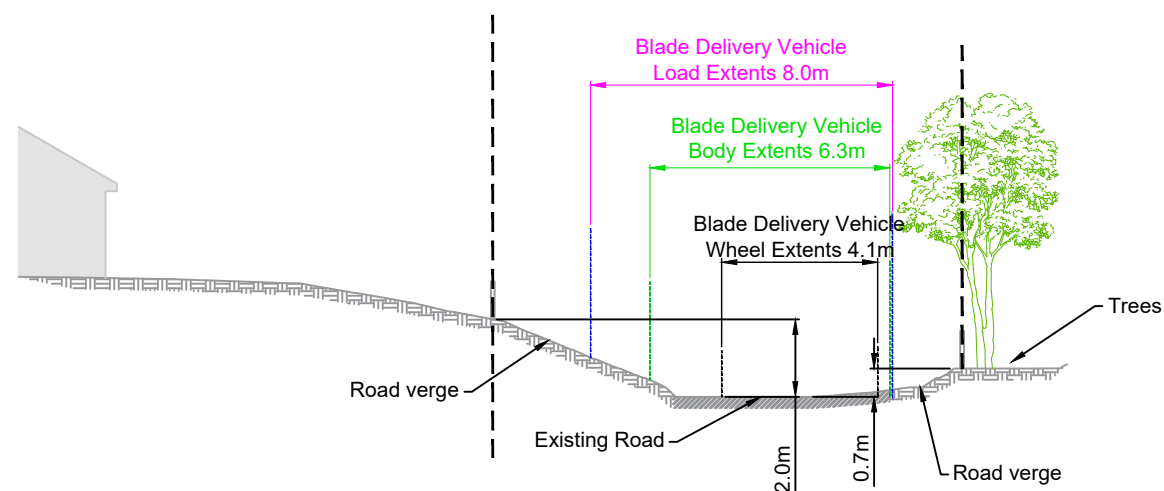

SECTION D-D
SCALE - 1:200



CARNBUCK WIND FARM

FIGURE APPENDIX 12.1

DELIVERY ANALYSIS

PROPOSED TEMPORARY REMOVAL OF BOUNDARY GATE & FENCE

PROPOSED CARNBUCK WIND FARM SITE ENTRANCE (SAME AS EXISTING GRUIG WINDFARM ENTRANCE)

326.0

KEY:

- EXISTING ROAD / TRACK SURFACE
- OVERRUN (HIGHWAY)
- OVERRUN (HIGHWAY)
- OVERRUN (3rd PARTY)
- OVERRUN (3rd PARTY)

VEHICLE PATH

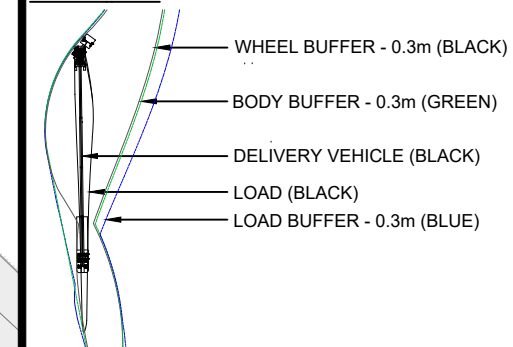

NOTES

1. AREAS OF OVERRUN AND OVERRUN CONSIDER THE COMBINED AREA FOR ALL ASSESSED VEHICLES.
2. VEHICLE DIMENSIONS BASED ON TYPICAL DELIVERY VEHICLES AND SHOULD BE CONFIRMED PRIOR TO DELIVERY.
2. VEHICLE MODELS HAVE A 0.3m FACTOR OF SAFETY.
3. LAND TAKE IS APPROXIMATE AND INCLUDES OVERRUN, OVERRUN AND TEMPORARY WORKS.
4. ALL RELEVANT AUTHORITIES TO BE CONSULTED ON RELOCATION / REMOVAL OF STREET FURNITURE.
5. VEGETATION WILL BE TRIMMED BACK WHERE REQUIRED WITHIN HIGHWAY CORRIDOR

DETAIL 22
SHEET 16 OF 16

LAYOUT DWG N/A T-LAYOUT NO. N/A

DRAWING NUMBER **03090-RES-ACC-DR-LO-001** REV **1**

SCALE - 1:500 @ A3

**ENVIRONMENTAL STATEMENT
2022**

DETAIL 22
V136 BLADE DELIVERY VEHICLE
REAR AXLE MANUAL OVERRIDE USED

THIS DRAWING IS THE PROPERTY OF RENEWABLE ENERGY SYSTEMS LTD. AND NO REPRODUCTION MAY BE MADE IN WHOLE OR IN PART WITHOUT PERMISSION